

SITE DATA

ZONING:	SHOPPING CENTER		
TOTAL SITE AREA:	1,055,111 SF (24.2 ACRES)		
BUILDING	AREA	PARKING RATIO	REQ. PARKING
MAJOR RETAIL	103,000 SF	4.5/ 1,000 SF	484
JR MAJOR RETAIL	48,000 SF	4.5/ 1,000 SF	216
PAD RETAIL	50,900 SF	4.5/ 1,000 SF	229
DRIVE THRU RESTAURANT	21,500 SF	10/ 1,000 SF	215
TOTAL	220,800 SF		1,124
ALLOWED FOOD USE			
10% OF RETAIL @ 4.5/1,000 PARKING RATIO (201,900 SF)			20,180 SF
DRIVE THRU RESTAURANT			21,600 SF
TOTAL ALLOWED FOOD USE			41,680 SF
SITE COVERAGE	20.8%		

PARKING DATA

TOTAL PROVIDED PARKING STALLS	1,124 (5.1/ 1,000 SF)
COMPACT PARKING STALLS	285 (26%)
TOTAL ADA PARKING STALLS ADA VAN ACCESSIBLE STALLS	
BIKE PARKING REQUIREMENT:	58 SPACES (5% OF TOTAL PARKING PROVIDED)

LEGEND

- 25/50' FIRE TURNING RADIUS
- PARKING LOT AREA LIGHT ON 2' CONC. BASE
- LIGHTED BOLLARD
- ENTRY DECORATIVE AREA LIGHT
- SEMI TRUCK TURNING RADIUS
- PASSENGER VEHICLE TURNING RADIUS

VICINITY MAP



THE RIDGE

ELK GROVE, CA

SITE PLAN
SHEET A100

DATE: 07-23-2015
PROJECT NO: 1111-0004
SCALE:
SHEET:



ELK GROVE BOULEVARD

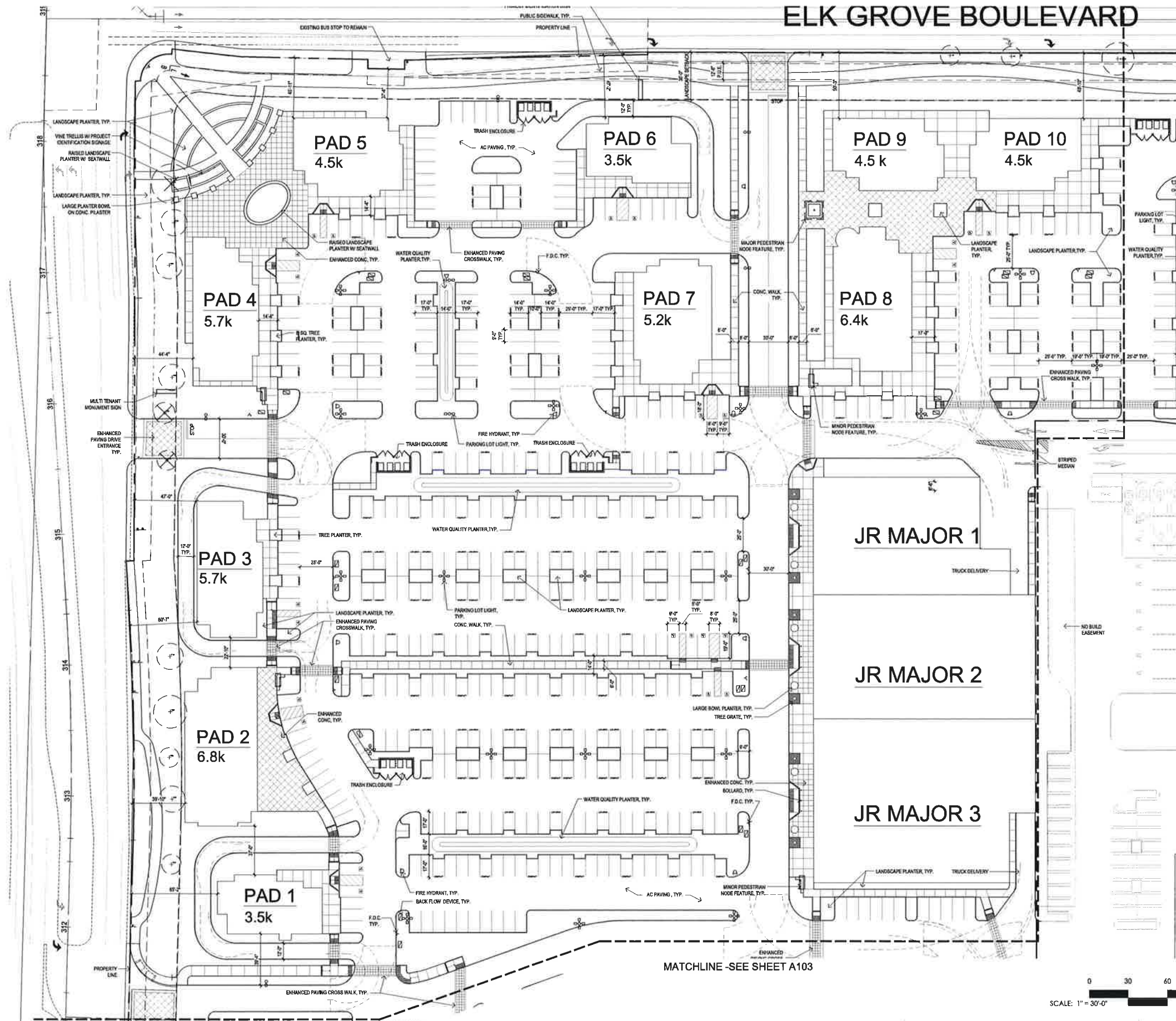

MATCHLINE - SEE SHEET A102

MATCHLINE - SEE SHEET A103

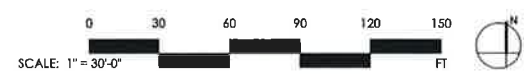

THE RIDGE

ELK GROVE, CA

SITE PLAN
SHEET A101

DATE: 07-23-2015
PROJECT NO: 1111-0004
SCALE:
SHEET:



2484 Natomas Park Drive Suite 100 Sacramento CA 95833
916 443 0335 lpasdesign.com Architecture + Design

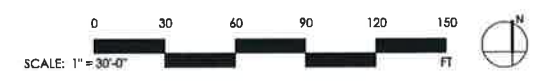
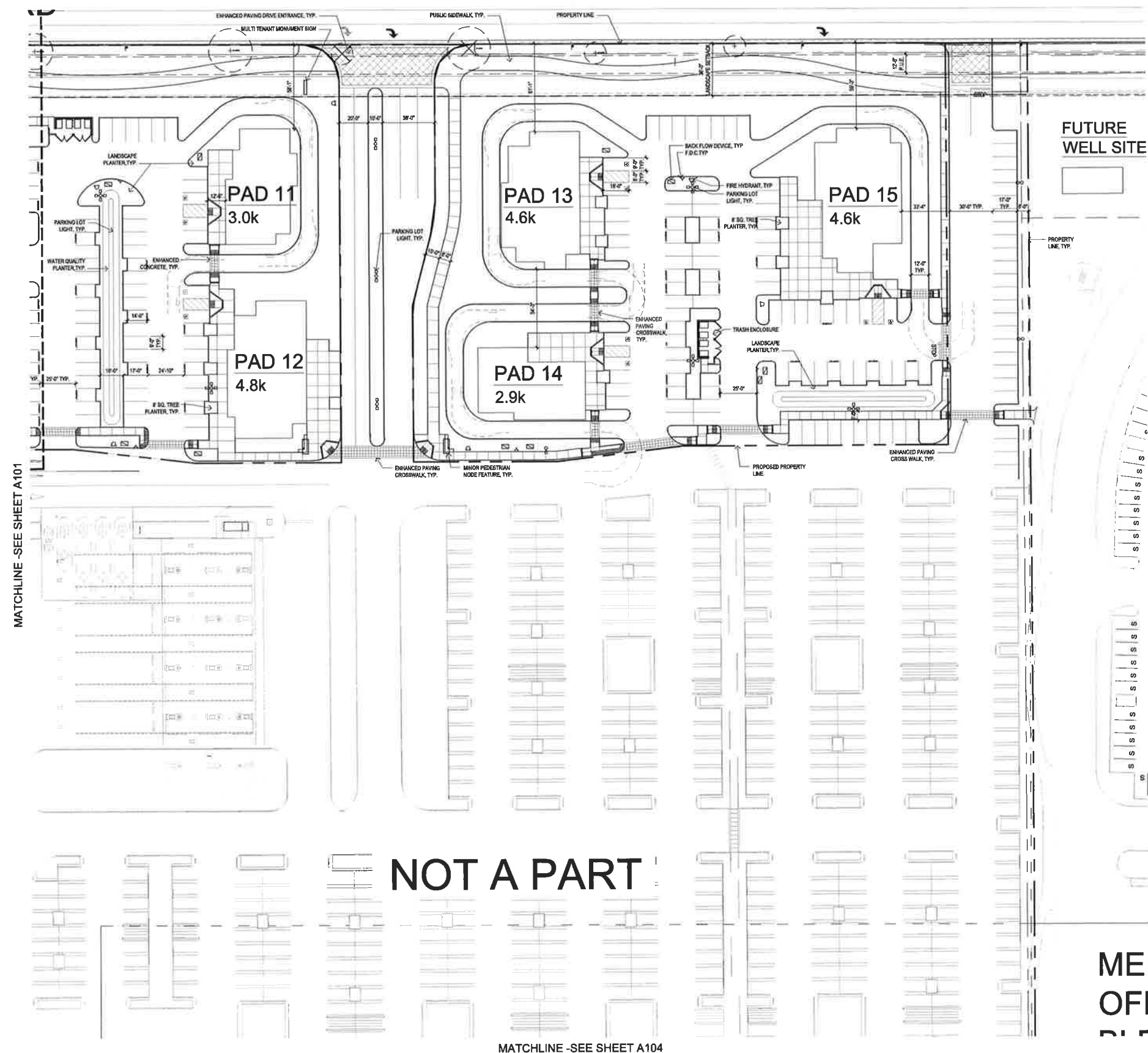

THE RIDGE

ELK GROVE, CA

SITE PLAN SHEET A102

DATE: 07-23-2015
 PROJECT NO: 1111-0004
 SCALE:
 SHEET:

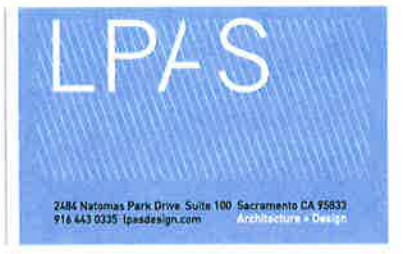

MATCHLINE -SEE SHEET A101

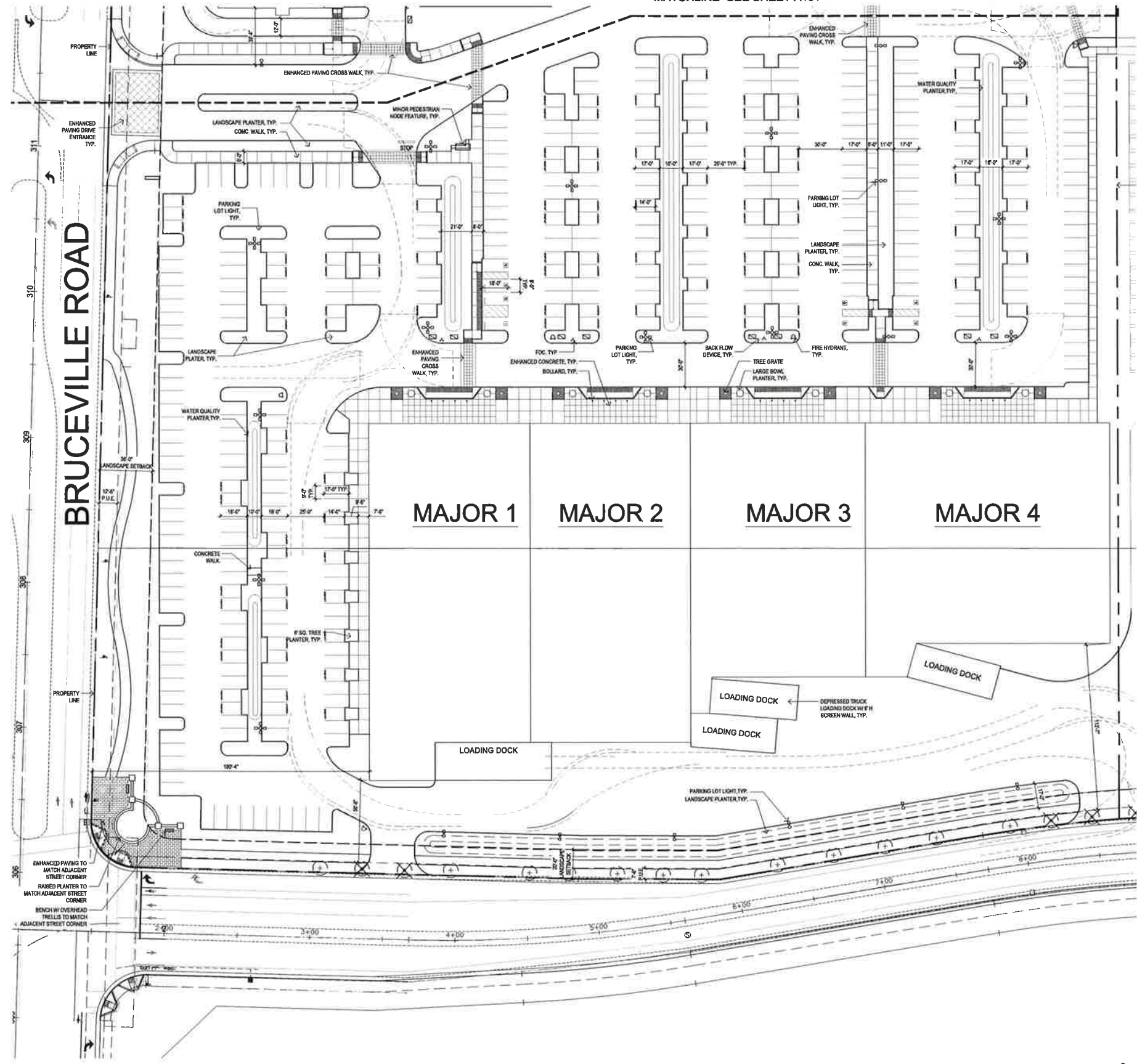

MATCHLINE -SEE SHEET A104

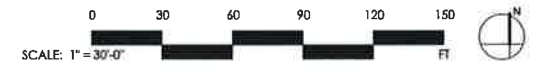

THE RIDGE

ELK GROVE, CA

SITE PLAN
SHEET A103

DATE: 07-23-2015
PROJECT NO: 1111-0004
SCALE:
SHEET:

